

Location

Location Map

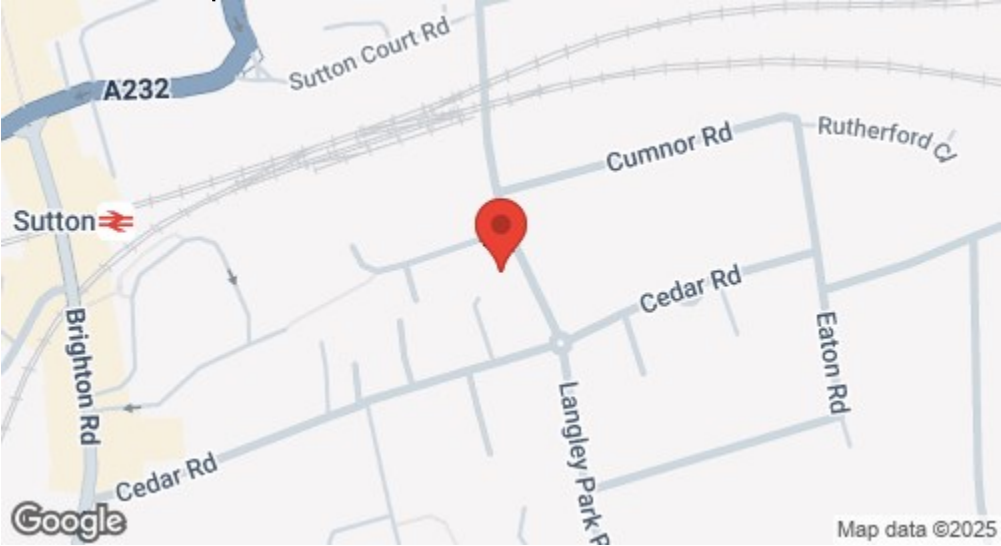

EPC Graph

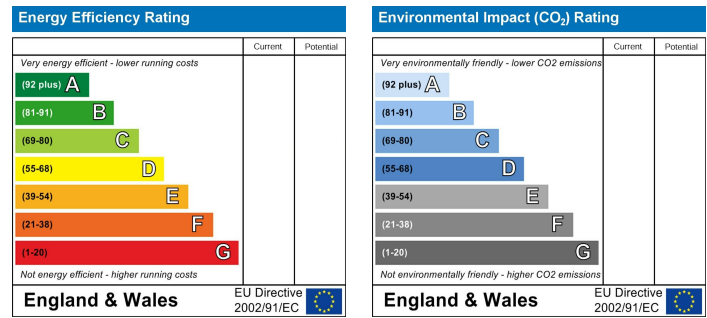

Important Note

Centro Residential Sales and Lettings limited have not tested any services, heating system, electrical system, appliances, fixtures and fittings, that may be included in this property and would advise interested parties to satisfy themselves as to their condition or investigating the presence of any deleterious materials.

Viewing: Strictly by appointment through:

CENTRO RESIDENTIAL SALES AND LETTINGS LIMITED

Tel: 020 8401 5000

E-mail: residential@centro.plc.uk

See a selection of our properties at www.centro.plc.uk

£925 Per Month - 6th June 2025

Langley Park Road, Sutton, SM2 5EN



Description

- Brand New Room to Rent
- Private Ensuite
- Shared Kitchen
- Large Courtyard
- Single Occupant Only
- Ground Floor
- Furnished or Unfurnished
- EPC Rating TBC
- Short Walk to Sutton Station
- Council Tax, Electric, Water & Weekly Cleaner - Additional £150.00pcm

Features

- Electric Heating
- Double Glazing
- Laminate Flooring

What you need to know

- Term: 12 months
- Rent: £925pcm exclusive of bills
- Security deposit: £1067.00
- Council Tax, Electric, Water & Weekly Cleaner - Additional £150.00pcm
- Energy Rating: TBC



Floor Plan

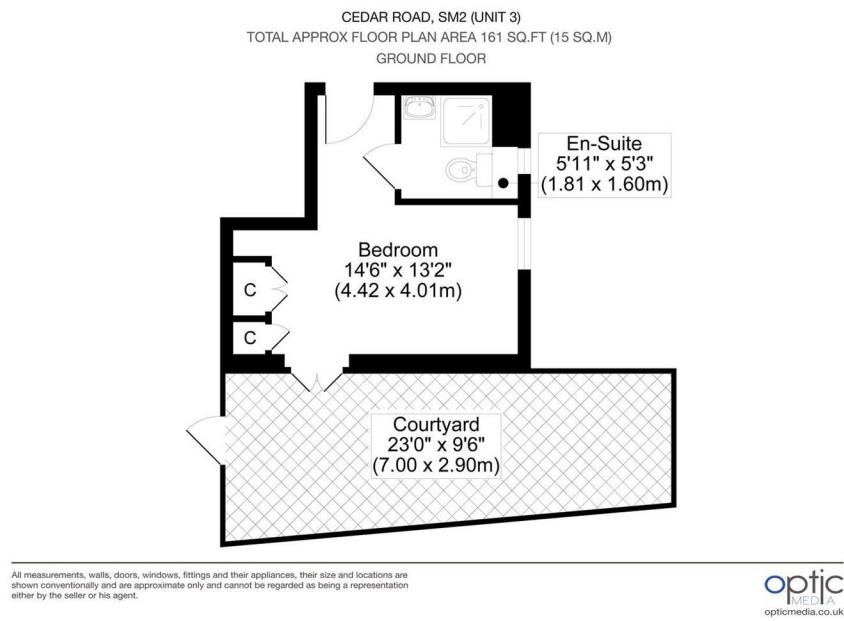

For illustration purposes only



All dimensions and measurements are approximate and for guidance only.

Just Centro's Opinion...

BRAND NEW ROOM TO RENT WITH PRIVATE ENSUITE AND COURTYARD - SINGLE OCCUPANT ONLY

A brand new room to rent, offering a modern and comfortable living space, Located within a thoughtfully designed building of eight flats spread across three floors, this room on the Ground floor benefits from its own private ensuite and direct access to a large courtyard.

The shared kitchen, situated on the lower ground floor, is fully equipped with a breakfast bar, two cookers, two hobs, two fridge freezers, a dishwasher, washing machine, and dryer—ideal for those who enjoy cooking and socialising.

Perfectly positioned within walking distance of Sutton Rail Station and the vibrant High Street, the property offers excellent access to transport links and local amenities.

Offered furnished or unfurnished, this room is available to view now!

Please note: Council Tax, electricity, water, and a weekly cleaner are charged at an additional £150.00 per month.

Additional Photos

