



www.centro-pic.uk | Telephone 020 8401 5000
www.christiesworld.com | Telephone 020 8643 7777

MAYFAIR
OFFICE.CO.UK

onTheMarket.com

zoopla.co.uk

rightmove

RICS

The Property Ombudsman

CHRISTIES

optica
MEDA
optimedia.co.uk

All measurements, walls, doors, windows, fittings and their appliances, their size and locations are shown conventionally and are approximate only and cannot be regarded as being a representation either by the seller or his agent.

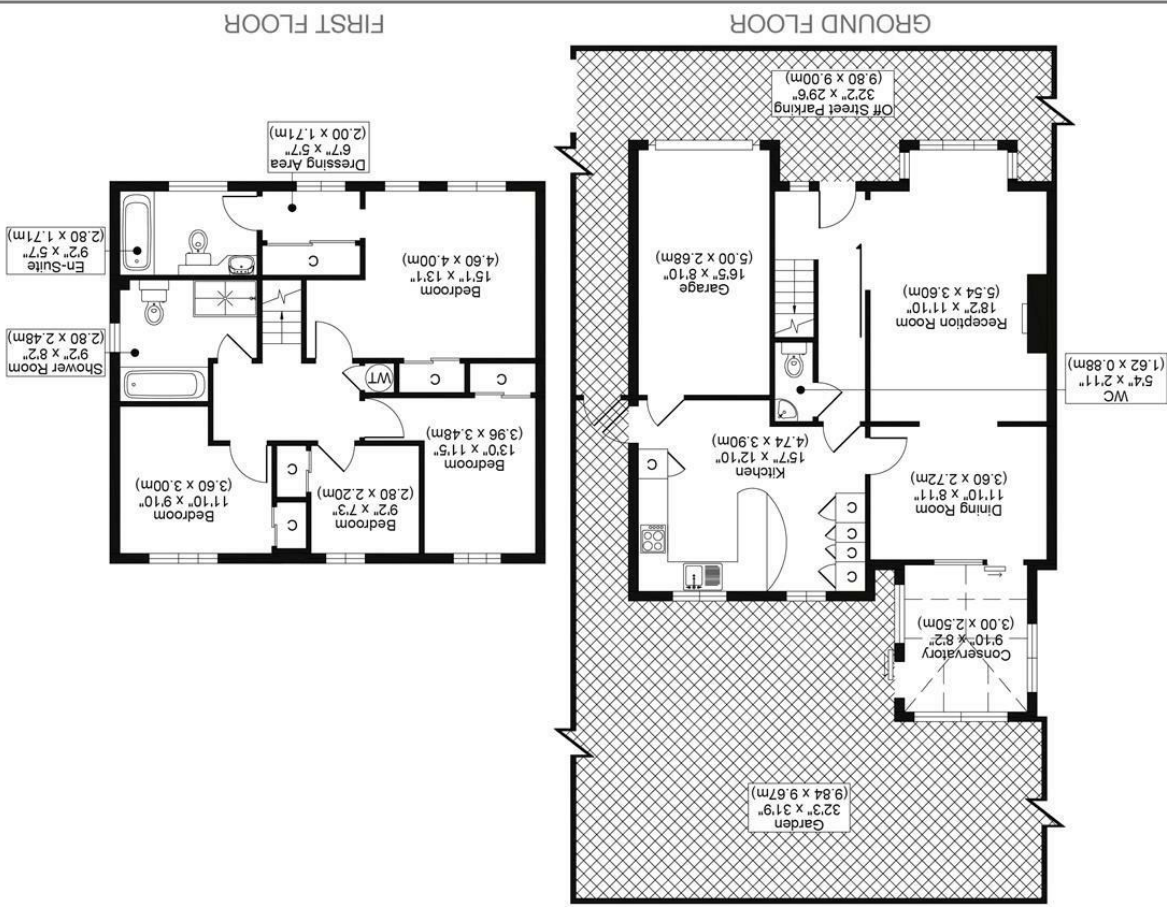

HOMELAND DRIVE, SM2
TOTAL APPROX FLOOR PLAN AREA INCLUDING GARAGE 1504 SQ.FT (140 SQ.M)
TOTAL APPROX FLOOR PLAN AREA EXCLUDING GARAGE 1352 SQ.FT (126 SQ.M)



CHRISTIES



GUIDE PRICE £750,000 - £800,000

NESTLED IN THE DESIRABLE AREA OF HOMELAND DRIVE, SUTTON, THIS SPLENDID, DETACHED HOUSE OFFERS A PERFECT BLEND OF COMFORT AND MODERN LIVING. WITH FOUR GENEROUSLY SIZED BEDROOMS, THIS PROPERTY IS IDEAL FOR FAMILIES SEEKING AMPLE SPACE TO GROW AND THRIVE. THE TWO WELL-APPOINTED BATHROOMS – INCLUDING A PRIVATE ENSUITE TO THE PRINCIPAL BEDROOM – ENSURE CONVENIENCE FOR ALL RESIDENTS, MAKING DAILY ROUTINES SMOOTH AND STRESS-FREE.

ADDING TO ITS APPEAL IS A BEAUTIFULLY MAINTAINED GARDEN, OFFERING A PRIVATE OUTDOOR RETREAT FOR RELAXATION, PLAY, OR AL FRESCO DINING. IT IS AN IDEAL SPACE FOR BOTH CHILDREN AND ADULTS TO ENJOY THE OUTDOORS FROM THE COMFORT OF HOME.

PARKING IS HASSLE-FREE WITH A LARGE DRIVEWAY—AN INCREASINGLY VALUABLE FEATURE IN TODAY’S BUSY WORLD. THIS PROPERTY NOT ONLY MEETS THE PRACTICAL NEEDS OF MODERN LIFE BUT ALSO OFFERS A WARM AND INVITING ATMOSPHERE THAT YOU WILL BE PROUD TO CALL HOME.

WITH ITS EXCELLENT LOCATION, SPACIOUS INTERIORS, LOVELY GARDEN, AND THOUGHTFUL DESIGN, THIS DETACHED HOUSE ON HOMELAND DRIVE IS A RARE FIND. IT PRESENTS AN EXCEPTIONAL OPPORTUNITY FOR THOSE LOOKING TO SETTLE IN A VIBRANT COMMUNITY WHILE ENJOYING THE COMFORTS OF A WELL-DESIGNED FAMILY HOME. DO NOT MISS THE CHANCE TO MAKE THIS DELIGHTFUL PROPERTY YOUR OWN.

- SOUGHT AFTER LOCATION
- ENSUITE TO THE MASTER
- POTENTIAL TO EXTEND (S.T.P.P)
- EPC RATING C
- COUNCIL TAX BAND G

