

Location

Location Map

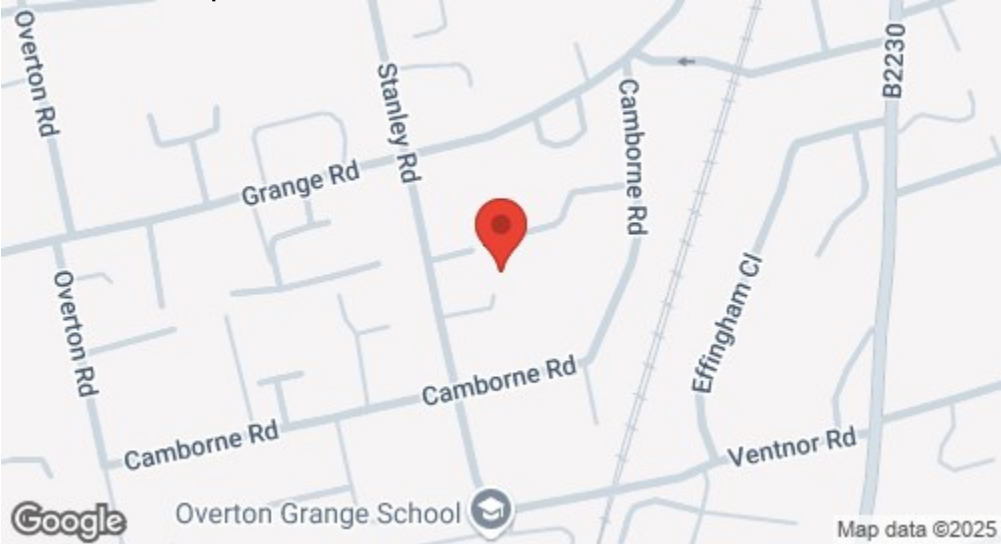

EPC Graph

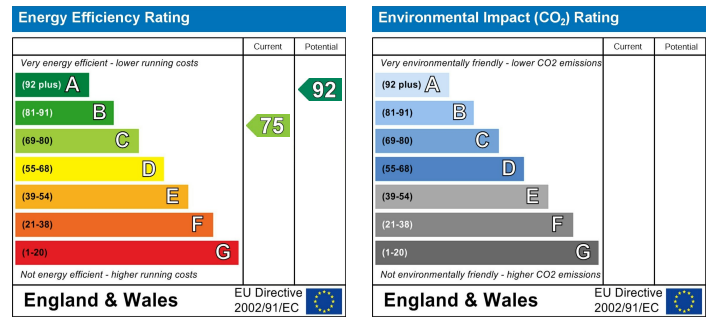

Important Note

Centro Residential Sales and Lettings limited have not tested any services, heating system, electrical system, appliances, fixtures and fittings, that may be included in this property and would advise interested parties to satisfy themselves as to their condition or investigating the presence of any deleterious materials.

Viewing: Strictly by appointment through:

CENTRO RESIDENTIAL SALES AND LETTINGS LIMITED

Tel: 020 8401 5000

E-mail: residential@centro.plc.uk

See a selection of our properties at www.centro.plc.uk

£1,850 Per Month - 1st April 2025

Tapestry Close, Sutton, SM2 6TD



Description

- Terraced House
- Two Bedrooms
- Private Garden
- Garage
- Cul-De-Sac Location
- Unfurnished
- EPC Rating : C
- Council Tax Band : D

Features

- Double glazing
- Gas central heating
- Garage

What you need to know

- Term: 12 months
- Rent: £1850pcm exclusive of bills
- Security deposit: £2134.00
- Council Tax band: D
- Energy Rating: C



Floor Plan

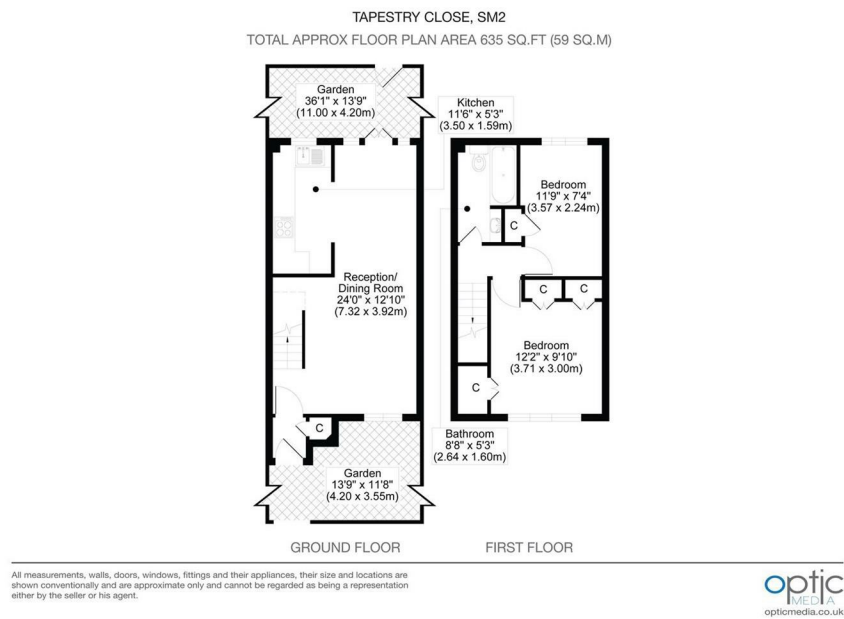

For illustration purposes only



All dimensions and measurements are approximate and for guidance only.

Just Centro's Opinion...

Nestled in the quiet cul-de-sac of Tapestry Close, this charming two-bedroom terraced house offers a delightful blend of comfort and convenience.

The property features a large through lounge, kitchen with appliances, two bedrooms both with built in storage and a modern family bathroom. The property also benefits from a private rear garden, garage, gas central heating and double glazing throughout.

The proximity to Sutton Station makes commuting a breeze. Families will appreciate the excellent selection of schools nearby, including Devonshire Primary School, Overton Grange Secondary School and Harris Academy Sutton.

Offered unfurnished and available now.

Additional Photos

